

W 11

AN ORDINANCE AMENDING KING COUNTY ZONING RESOLUTION NO. 25789, AS AMENDED BY AMENDING THE ZONING MAP THEREOF RECLASSIFYING CERTAIN PROPERTY

WHEREAS EULA FIRMINHAE, ET AL has petitioned King County, requesting reclassification of property described in said petition and all legal requirements have been performed; and

WHEREAS, the Department of Planning has transmitted to the King County Council, King County, Washington, a copy of the Department's findings and action recommending that the Zoning Map be amended and for the reasons stated therein; and

NOW THEREFORE BE IT ORDAINED that the King County Council does hereby adopt the findings and recommendations of the Department of Planning as its own and does hereby reclassify certain property to BN as shown hereon and legally described herein which lies within the part(s) of the Zoning Map described as Area Map(s) E 36-22-5

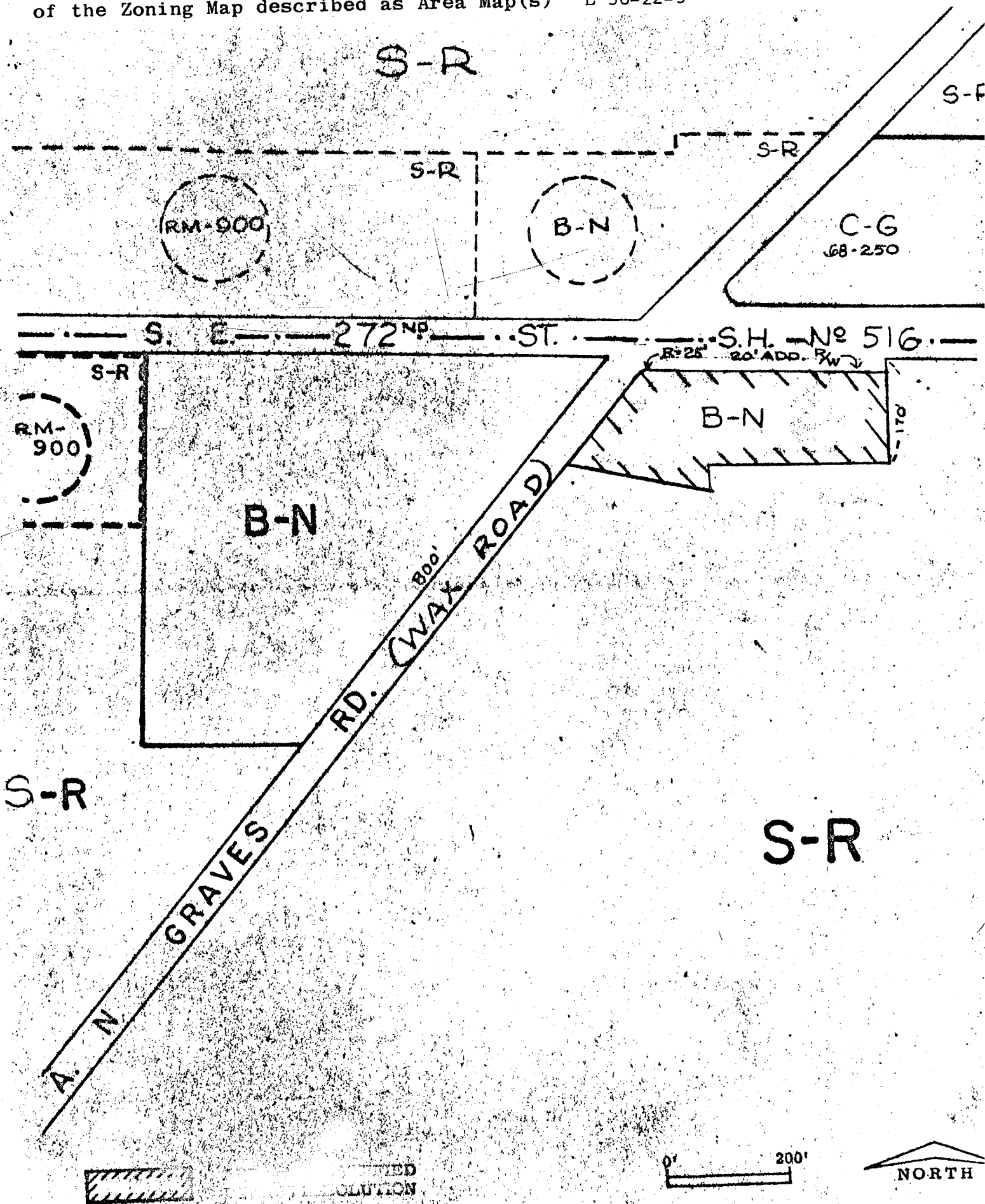

LEGAL DESCRIPTION:

That portion of the northwest quarter of the northeast quarter of Section 36, Township 22 North, Range 5 East, W. M., beginning on the east line of said sub-division at a point south 0 degrees east 372.89' from the northeast corner thereof; thence south 89° west 335.13' more or less, to the southeasterly line of Graves County Road, thence north 40° east along said southeasterly line 208.7' to the true point of beginning; thence north 40° east along said southeasterly line 173.07' thence north 45° east 119.51' to the northeast corner of said sub-division; thence south 0 degrees east along easterly line thereof 242.89' thence westerly in a straight line to the true point of beginning, ALSO the north 200' of the west half of the west half of the northwest quarter of the northeast quarter of the northeast quarter of Section 36, Township 22 North, Range 5 East, W.M., ALSO the west 145' of the north 200' of the east half of the west half of the northwest quarter of the northeast quarter of the northeast quarter of Section 36, Township 22 North, Range 5 East, W.M., less County roads.

INTRODUCED and read for the first time this 11<sup>th</sup> day of August, 1969.

PASSED by the Council at a regular meeting thereof on the 18<sup>th</sup> day of August, 1969.

John T. O'Brien  
Chairman of the County Council

ATTEST:

Ray Olson  
ACTING Clerk of the Council

APPROVED this \_\_\_\_\_ day of \_\_\_\_\_, 1969.

\_\_\_\_\_  
King County Executive

ORDINANCE RECORDED  
1st Aug 11, 1969  
2nd Aug 18, 1969  
3rd Aug 18, 1969  
Effective Date \_\_\_\_\_